

FOR TYPICAL CABINET LOADINGS,
FASTEN CABINET TO PANELS FOLLOWING CABINET
MANUFACTURER'S RECOMMENDATIONS.
FOR EXTREME CABINET LOADS CONSULT
FORCE PANELS BEFORE INSTALLATION.

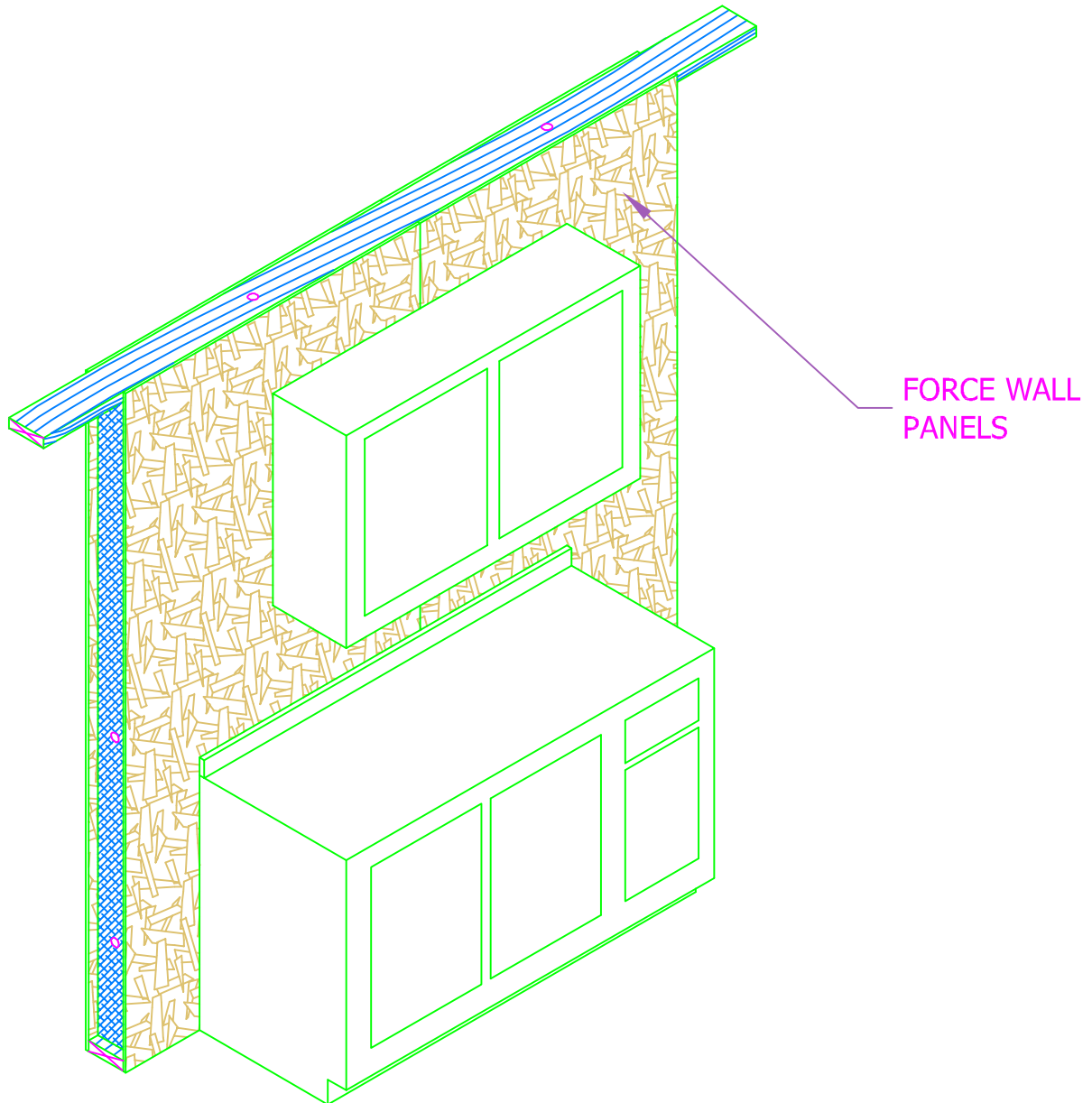

PBS-209

TYPICAL CABINET CONNECTION
FORCE PANELS



FORCE
PANELS